

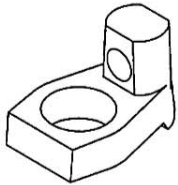

B

Flag terminal with 3/8"
diameter hole
(T876)



G

Offset post with
horizontal hole,
stainless steel 5/16"
bolt & hex nut
(T881)

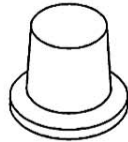

S

SAE "Automotive Post"
(TSAE)



T

Heavy Duty "L"
terminal with 3/8"
diameter hole
(T975)

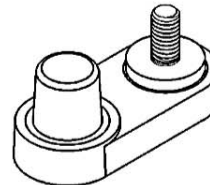

U

Molded-in offset
SAE post & vert
5/16" NEG. & 5/16"
POS. stainless steel
studs & wing nuts

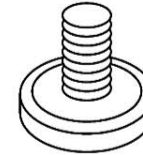

X

3/8" - 16 stainless
steel threaded post
(STUD)

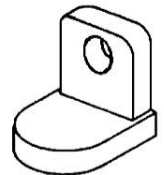

Y

Small "L" terminal
with 1/4" - 20
round hole
(T873)