

ES20-12FR HR

SPECIFICATIONS

Nominal Voltage (V): 12V

Nominal Capacity:

20hour rate (1.0A to 10.50V) 20Ah

10hour rate (2.0A to 10.50V) 19Ah

5hour rate (3.4A to 10.20V) 17Ah

1C (20A to 9.60V) 14Ah

3C (60A to 9.60V) 10.2Ah

W/Cell to 1.67 End Voltage (15 Min. Rate) 80

Weight: 13.76 Lbs. (6.24 kg)

Internal Resistance (at 1KHz): 10 mΩ

Maximum Discharge Current for 30 seconds: 400A

Maximum Discharge Current for 5 seconds: 800A

Operating Temperature Range:

Charge 0°C(32°F) to 40°C (104°F)

Discharge -15°C(5°F) to 50°C (122°F)

Storage -15°C(5°F) to 40°C (104°F)

Charge Retention (shelf life) at 20°C (68°F):

1 month 92%

3 month 90%

6 month 80%

Charging Methods at 25°C (77°F)

Cycle use: Charging Voltage 14.4 to 15.0V
Maximum Charging Current 6A

Standby use: Float Charging Voltage 13.50 to 13.80V

Life expectancy

Cycle Use: 100% depth of discharge 225 cycles
80% depth of discharge 250 cycles
50% depth of discharge 750 cycles

Standby Use: 3~5 years

Case Material: ABS UL94-V0 flame retardant case/cover

Terminal: F3

Maintenance-Free Rechargeable Sealed Lead-Acid Battery



DIMENSIONS

mm(inch)

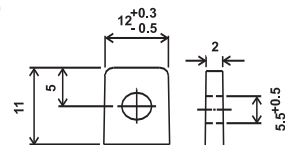

F3
(M5 Bolts)

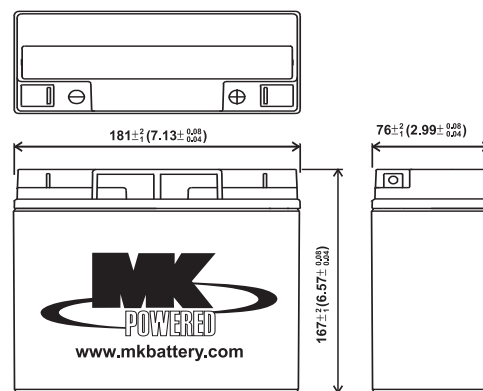

(v) FOR 12V BATTERY
Discharge Time VS. Discharge Current (25°C)

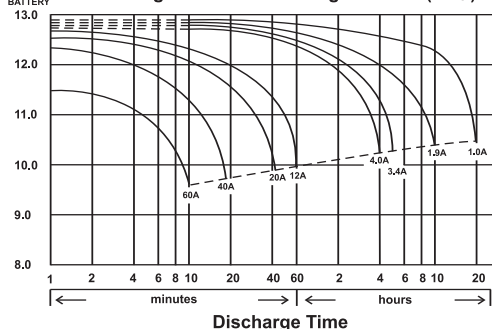

MK Battery

1645 South Sinclair Street • Anaheim, California 92806

Toll Free: 800-372-9253 • Fax: 714-937-0818 • E-Mail: sales@mkbattery.com

